

FOR SALE

Outparcel for Sale 2.2+/- Acres Deland, Florida



Location: SEC of Orange Camp Road and Victoria Commons Boulevard, Deland, FL. At the entrance to the Victoria Park residential community and across from new retail center and in front of 25,000 sf medical office.

Size: 2.2± acres

Zoning: P-D, within "Emerging Gateway District"

Demographics: Over 75,000 in 5 mile radius

Price: \$1,000,000

www.delandsite.com

Exclusively listed by
Cushman & Wakefield of Florida, Inc.

Contact:
BETSY OWENS betsy.owens@cushwake.com
MINDY BOEHM mindy.boehm@cushwake.com
MARGERY JOHNSON margery.johnson@cushwake.com
Phone: 407.841.8000

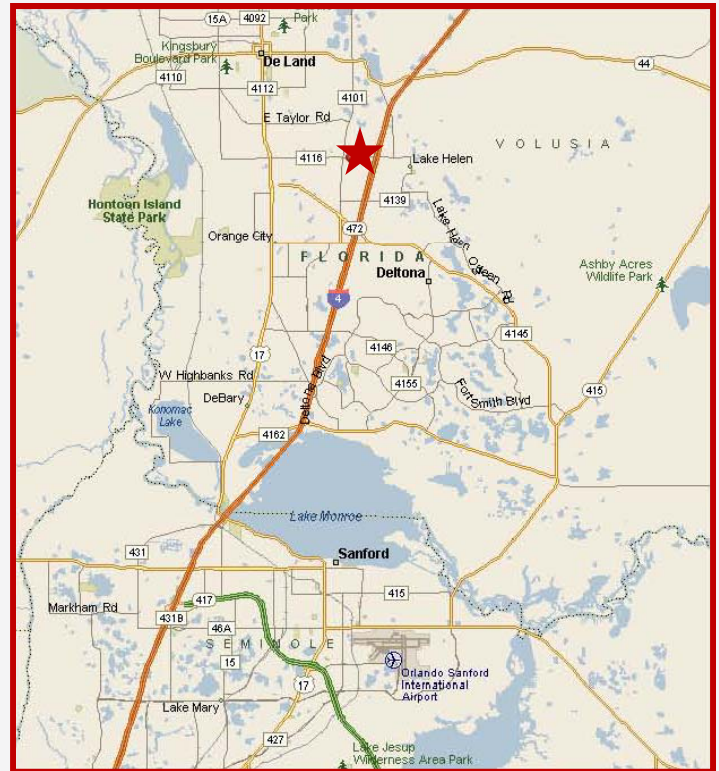

CUSHMAN & WAKEFIELD
Global Real Estate SolutionsSM
800 N. Magnolia Ave, Suite 450
Orlando, FL 32803

FOR SALE

Outparcel for Sale

2.2+/- Acres

Deland, Florida

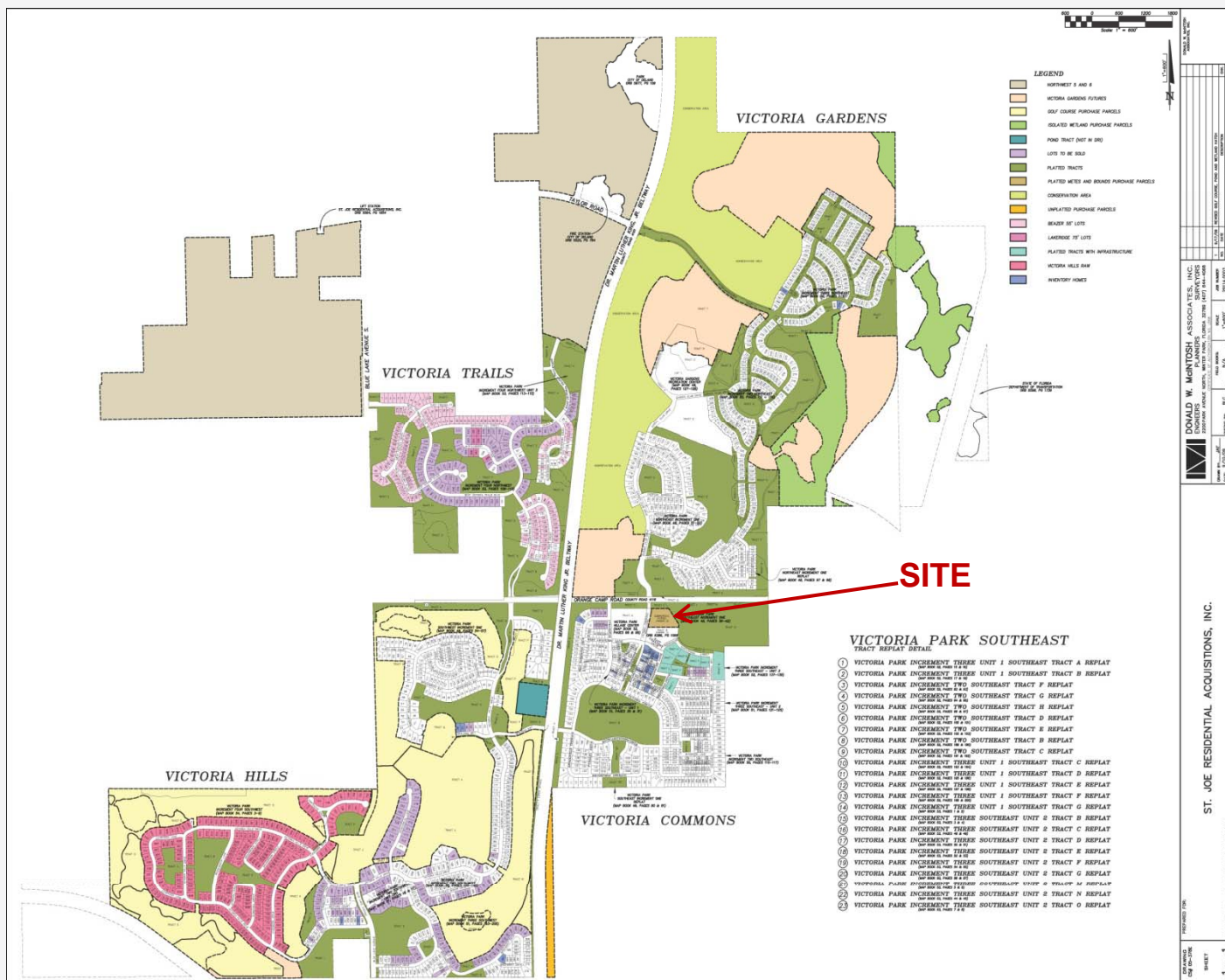

| Demographics (2010) | 1 Mile | 3 Mile | 5 Mile |
|--------------------------|----------|----------|----------|
| Population | 2,380 | 23,831 | 79,122 |
| Average HH Income | \$81,751 | \$55,669 | \$54,833 |
| Medium HH Income | \$64,789 | \$43,712 | \$43,703 |

A full commission computed and earned in accordance with the rates and conditions of our agency agreement with our principal, when received from our principal, will be paid to a cooperating broker who consummates a sublease which is unconditionally executed and delivered by and between sublandlord and subtenant. (A copy of the rates and conditions referred to above are available upon request.)

No warranty or representation, express or implied, is made as to the accuracy of the information contained herein, and same is submitted subject to errors omissions, change of price, rental or other conditions, withdrawal without notice, and to any specific listing conditions imposed by our principals.



800 N. Magnolia Avenue, Suite 450 Orlando, FL 32803